

Approval body for construction products  
and types of construction

Bautechnisches Prüfamt

An institution established by the Federal and  
Laender Governments



## European Technical Assessment

ETA-13/0385  
of 18 June 2018

English translation prepared by DIBt - Original version in German language

### General Part

Technical Assessment Body issuing the  
European Technical Assessment:

Deutsches Institut für Bautechnik

Trade name of the construction product

wedi Abdichtungssystem Bauplatte/Fundo

Product family  
to which the construction product belongs

Watertight covering kit for wet room floors and walls  
based on watertight boards

Manufacturer

wedi GmbH  
Hollefeldstraße 51  
48282 Emsdetten  
DEUTSCHLAND

Manufacturing plant

wedi GmbH  
Hollefeldstraße 51  
48282 Emsdetten

This European Technical Assessment  
contains

9 pages including 3 annexes which form an integral part  
of this assessment

This European Technical Assessment is  
issued in accordance with Regulation (EU)  
No 305/2011, on the basis of

ETAG 022 Part 3: "Kits based on inherently watertight  
boards",  
used as EAD according to Article 66 Paragraph 3 of  
Regulation (EU) No 305/2011.

This version replaces

ETA-13/0385 issued on 12 June 2013

European Technical Assessment  
ETA-13/0385  
English translation prepared by DIBt

Page 2 of 9 | 18 June 2018

The European Technical Assessment is issued by the Technical Assessment Body in its official language. Translations of this European Technical Assessment in other languages shall fully correspond to the original issued document and shall be identified as such.

Communication of this European Technical Assessment, including transmission by electronic means, shall be in full. However, partial reproduction may only be made with the written consent of the issuing Technical Assessment Body. Any partial reproduction shall be identified as such.

This European Technical Assessment may be withdrawn by the issuing Technical Assessment Body, in particular pursuant to information by the Commission in accordance with Article 25(3) of Regulation (EU) No 305/2011.

## Specific part

### 1 Technical description of the product

"wedi Abdichtungssystem Bauplatte/Fundo" is a watertight covering kit. This kit consists of the following components:

- Watertight boards "wedi Bauplatte" for walls and floors on the basis of an extruded polystyrene foam (XPS), on both sides coated with mortar on the basis of modified cement reinforced with a glass fiber fleece.

Main dimensions:	Length:	from 1250 mm to 2600 mm
	Width:	from 600 mm to 1200 mm
	Thickness:	from 4 mm to 100 mm

Other dimensions for length and width can be cut from the board.

- Watertight board "wedi Fundo" Primo for floors on the basis of an extruded polystyrene foam (XPS), both sides coated with mortar on the basis of modified cement reinforced with a glass fiber fleece. The board has an integrated slope in direction to the prefabricated penetration for the floor gully. The boards are available in different geometries (circle, square, quadrant, spiral) and sizes.

Main dimensions:	Length:	from 900 mm to 1900 mm
	Width:	from 900 mm to 1515 mm
	Thickness:	from 20 mm to 50 mm

Other dimensions for length and width can be cut from the board.

- Adhesives for fixing the board on substrate and for tiles on the basis of cement mortar, CE-marked according EN 12004<sup>1</sup>:

wedi 320	SCHÖNOX CFK Plus	ARDEX 77
Mapei Keraflex S1	Sopro`s No.1	Alfix Universalfix
Mapei Adesilex P9	Sopro`s FF 450	
SCHÖNOX PFK Plus	Sopro`s No.1 schnell	

- Adhesive "wedi 610" for fixing the joint of the boards and the sealing details

- Sealing tape "wedi Tools Dichtband", width: 100 mm or 120 mm

- Sealing sleeve for corners, penetrations and floor gullies:

"wedi Tools Dichtecken" side length 120 mm

"wedi Tools Dichtmanschetten" 120 x 120 mm or 250 x 250 mm

The kit is intended to be used on a substrate and under a wearing surface, e. g. tiles. The wearing surface and its jointing material are not part of the kit, but are considered during the assessment of the intended use of the product.

Annex A1 shows the system build-up and Annex A2 shows the sealing details.

<sup>1</sup>

EN 12004:2007

Adhesives for tiles - Requirements, evaluation of conformity, classification and designation

## 2 Specification of the intended use in accordance with the applicable European Assessment Document

The intended use of the watertight covering kit under a wearing surface is to create a floor and wall watertight covering for indoor wet areas at possible operating temperature of 5 °C till 40 °C.

The following uses are intended:

- Floor and/or wall surfaces with only occasional direct exposure to water, e. g. at a good distance from shower or bathtub;
- Floor and/or wall in shower areas or around bathtubs used for a few showers daily, e. g. in ordinary dwellings, multifamily houses and hotels;
- Floor and/or wall surfaces with exposure to water more frequent or of longer duration than normally anticipated in dwellings, e. g. public wet rooms, schools and sport facilities.

The watertight board is intended to be used on flexible substrates e. g. plywood, chipboard, gypsum, anhydrite or similar material vulnerable to water and on rigid substrates e. g. masonry or concrete.

The product should be used in connection with the following types of gullies:

Stainless steel, plastics – type PE, PP and ABS – with clamping ring and collar or prefabricated by wedi GmbH, plastic – type PBT/PC

The gullies are not part of the kit. It is up to the responsibility of the user to use suitable products of the given type.

The performances given in Section 3 are only valid if the watertight covering kit is used in compliance with the specifications and conditions given in Annex B.

The verifications and assessment methods on which this European Technical Assessment is based lead to the assumption of a working life of the watertight covering of at least 25 years. The indications given on the working life cannot be interpreted as a guarantee given by the producer, but are to be regarded only as a means for choosing the right products in relation to the expected economically reasonable working life of the works.

## 3 Performance of the product and references to the methods used for its assessment

### 3.1 Safety in case of fire (BWR 2)

Essential characteristic	Performance
Reaction to fire	See Annex A1

**3.2 Hygiene, health and the environment (BWR 3)**

Essential characteristic	Performance
Content, emission and/or release of dangerous substances	no performance assessed
Release scenarios regarding BWR 3: IA2 (in accordance with EOTA TR 034)	no performance assessed
Vapour permeability	See Annex A1, declared value
Watertightness	See Annex A1
Crack bridging ability	See Annex A1, category
Bond strength	See Annex A1, category
Scratching resistance	See Annex A1
Joint bridging ability	See Annex A1, category
Watertightness around penetrations	See Annex A1, category

**3.3 Safety and accessibility (BWR 4)**

Essential characteristic	Performance
Slipperiness	no performance assessed

**3.4 General aspects**

The verification of durability and serviceability is part of testing the essential characteristics and by additional tests on the kit respectively on the components:

Essential characteristic	Performance
Resistance to temperature	See Annex A1, category
Resistance to water	See Annex A1, category
Resistance to alkalinity	See Annex A1, category
Resistance to mechanical wear	See Annex A1, declared value
Cleanability	See Annex A1, declared value
Reparability	See Annex A1 and the statement of the manufacturer
Thickness	See Annex A1, declared value
Applicability	See Annex A1, declaration

The verification of durability and serviceability is only ensured if the specifications of intended use according to Annex B and the specifications of the technical file of the manufacturer are kept.

**4 Assessment and verification of constancy of performance (AVCP) system applied, with reference to its legal base**

In accordance with ETAG 022 used as EAD, the applicable European legal act is: 2003/655/EC.

The system to be applied is: 2+

In addition, with regard to e.g. reaction to fire for products covered by this EAD the applicable European legal act is 2001/596/EG.

The system to be applied is: 3

**5 Technical details necessary for the implementation of the AVCP system, as provided for in the applicable EAD**

Technical details necessary for the implementation of the AVCP system are laid down in the control plan deposited with Deutsches Institut für Bautechnik.

Issued in Berlin on 18 June 2018 by Deutsches Institut für Bautechnik

BD Dipl.-Ing. Andreas Kummerow  
Head of Department

*beglaubigt:*  
Gnamou

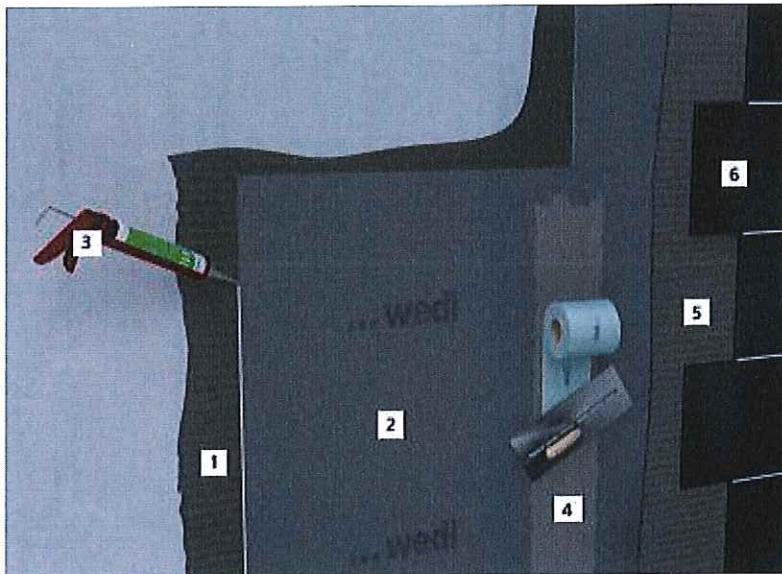

- 1 Adhesive (see Annex A2)
- 2 Watertight board "wedi Bauplatte"
- 3 Sealing mass "wedi 610" for the joints between the boards and for bonding the sealing details
- 4 Sealing tape "wedi Tools" Dichtband
- 5 Tile adhesive (see Annex A2)
- 6 Wearing surface (e. g. tiles) (not part of the kit)

Thickness of the watertight board 4 to 100 mm

Level of use categories according to ETAG 022 with relation to:

Crack bridging ability	category 1: 0.4 mm
Bond strength	category 2: 1 and 2: $\geq 0.2$ MPa or 0.3 MPa (see Annex A2)
Joint bridging ability	category 2: watertight
Water tightness around penetrations	category 2: watertight
Resistance to water	category 2: $\geq 0.5$ MPa
Resistance to temperature	category 2: $\geq 0,5$ MPa
Resistance to alkalinity	category 2: $\geq 0.5$ MPa

Performance of the product:

Working life	25 years
Reaction to fire acc. to EN 13501-1	class E
Statement on dangerous substance	see section 3.2
Water vapour diffusion resistance factor (23 °C – 75/100 % r.h.)	$s_d > 0.7$ m
Water tightness acc. to EN 13967	Watertight
Impermeability at sealings	pass
Scratch resistance	not relevant acc. ETAG 022-3
Resistance to mechanical wear	not relevant acc. ETAG 022-3
Cleanability	not relevant acc. ETAG 022-3
Dimensional Stability	longitudinal and transversal direction <+/- 0.1 %, thickness <+/- 5 %
Applicability	applicable
Reparability	reparable
Slipperiness	no performance assessed

wedi Abdichtungssystem Bauplatte/Fundo  
wedi GmbH

**System built up, characteristic values and classifications**

Annex A1

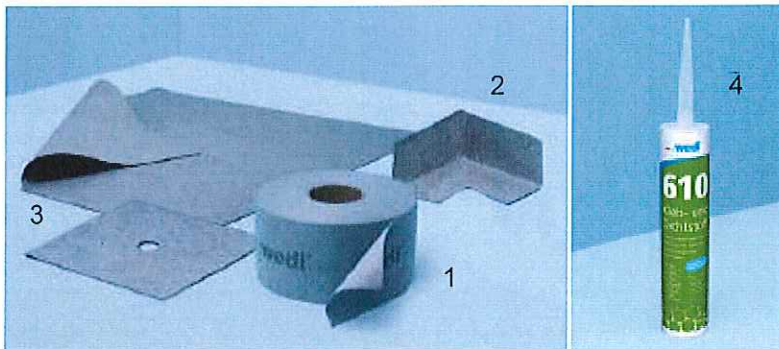

- 1 sealing tape "wedi Tools Dichtband", width: 120 mm
- 2 "wedi Tools Dichtecken" side length 120 mm
- 3 "wedi Tools Dichtmanschetten" 120 x 120 mm or 250 x 250 mm
- 4 Sealing mass for the joints of the boards "wedi 610"

Tile adhesives:	Bond strength category
wedi 320	2
Mapei Keraflex S1	
Mapei Adesilex P9	
SCHÖNOX PFK Plus	1
SCHÖNOX CFK Plus	
Sopro`s No.1	2
Sopro`s FF 450	
Sopro`s No.1 schnell	
ARDEX 77	
Alfix Universalfix	

Exampels of "wedi Fundo":



wedi Abdichtungssystem Bauplatte/Fundo  
wedi GmbH

Components

Annex A2



### Installation

The levels of use categories and the performance of the waterproofing kit can be assumed only, if the installation is carried out according to the installation instructions stated in the technical file of the manufacturer, in particular taking account of the following points:

- installation by appropriately trained personnel,
- installation of only those components which are specified components of the kit,
- installation with the required tools and adjuvant,
- precautions during installation,
- inspecting the substrate surface for cleanliness and correct treatment,
- inspecting during installation and of the finished watertight membrane and documentation of the results.

**wedi Abdichtungssystem Bauplatte/Fundo**  
wedi GmbH

**Intended use**  
Specifications

Annex B